

# Ciottina 21 stan br. 3

P = 92,32 m<sup>2</sup>

h = 2,95 m

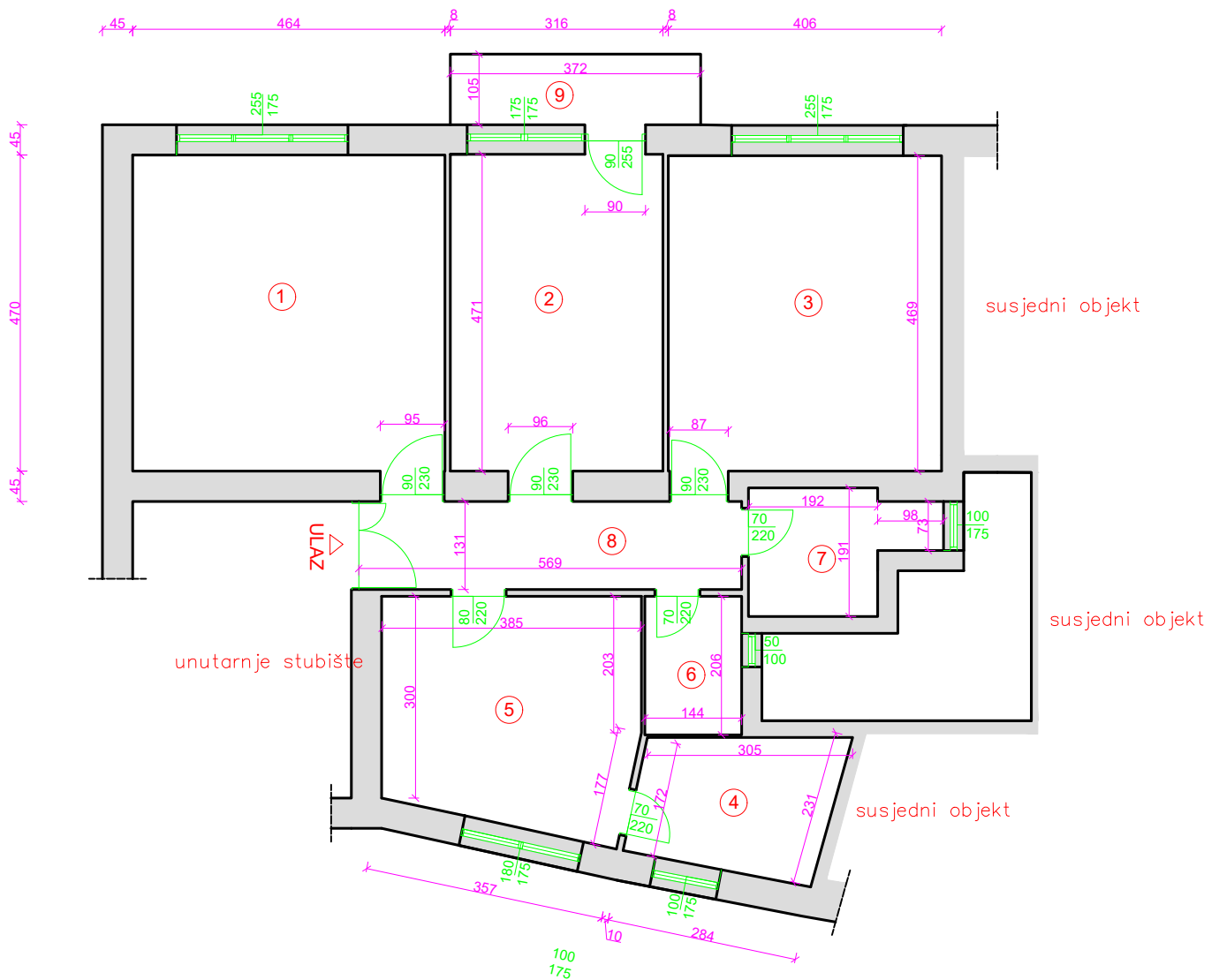

lipanj, 2020. g.

1. SOBA, P=22,08 m<sup>2</sup>, parket
2. SOBA, P=15,34 m<sup>2</sup>, parket
3. SOBA, P=19,29 m<sup>2</sup>, parket
4. SOBA, P=5,91 m<sup>2</sup>, teraco
5. KUHINJA I BLAGOVAONICA,  
P=12,91 m<sup>2</sup>, teraco
6. IZBA, P=2,97 m<sup>2</sup>, teraco
7. KUPAONICA + WC,  
P=4,38 m<sup>2</sup>, teraco
8. HODNIK, P=7,45 m<sup>2</sup>, teraco
9. BALKON, P=1,99 m<sup>2</sup>, cementna glazura,  
k=0,5