

Ružićeva 26 stan br. 7

$P = 39,10 \text{ m}^2$

$h = 2,73 \text{ m}$

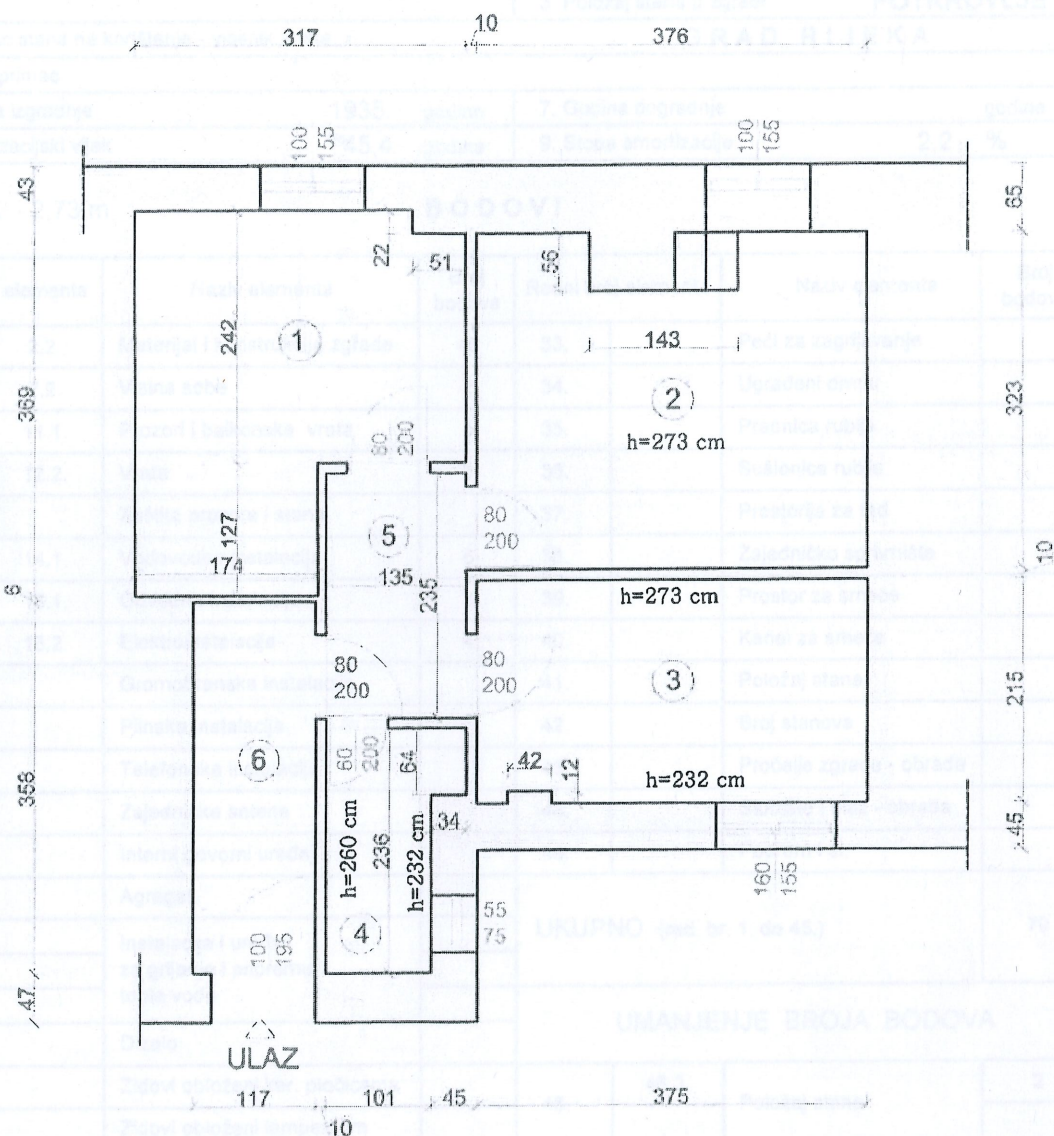

1. SOBA, $P= 9,77 \text{ m}^2$, parket
2. SOBA, $P= 11,34 \text{ m}^2$, parket
3. KUHINJA, $P= 8,03 \text{ m}^2$, teraco
4. KUPAONICA + WC,
 $P= 2,60 \text{ m}^2$, keramičke pločice
5. PREDSOBLJE, $P= 3,17 \text{ m}^2$, teraco
6. HODNIK, $P= 4,19 \text{ m}^2$, teraco

svibanj, 2020. g.