

Janka Polića Kamova 61
stan br. 9

$P = 38,53 \text{ m}^2,$
 $h = 2,50 \text{ m}$

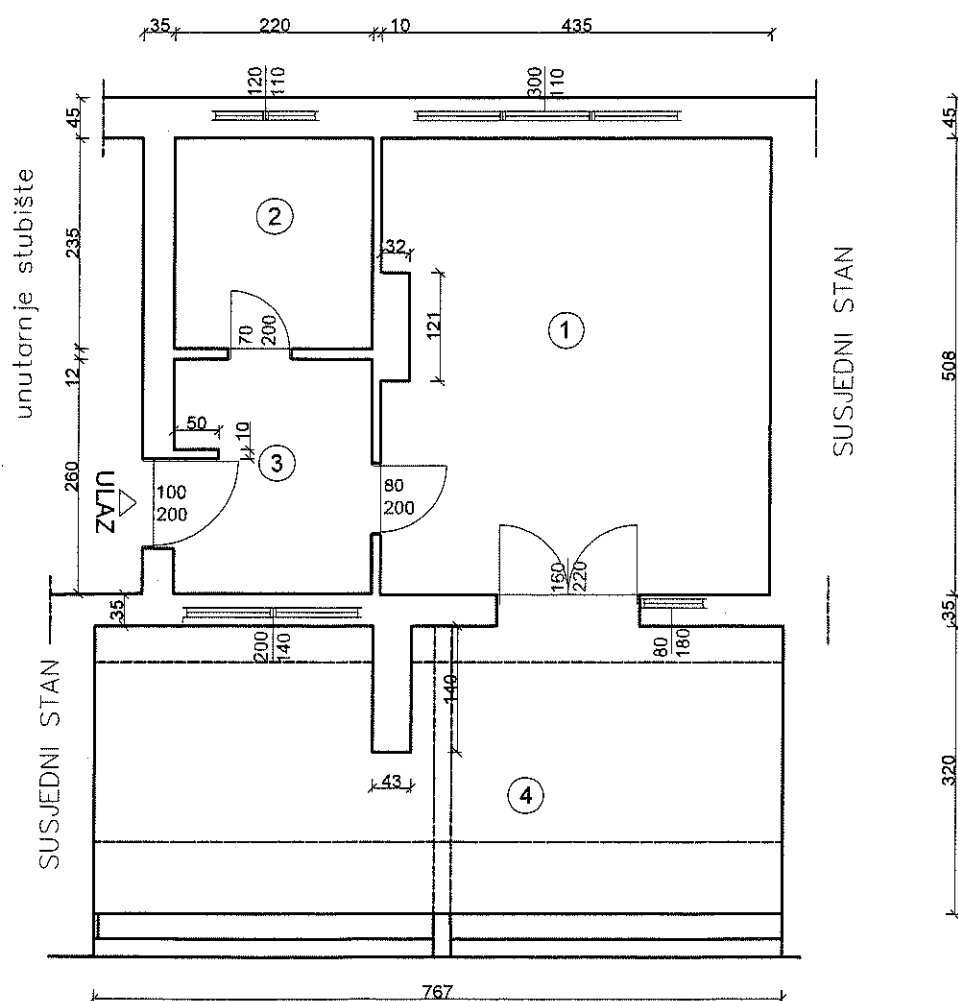

1. SOBA, $P=21,71 \text{ m}^2$, parket
2. KUPAONICA + WC, $P=5,17 \text{ m}^2$, ker. pločice
3. HODNIK S PROSTOROM ZA PRIPREMU
 $P=5,67 \text{ m}^2$, linoleum
4. TERASA, $k=0,25$, $P=5,98 \text{ m}^2$, teraco pločice

ožujak, 2023. g.